

HIGH BAY LIGHT HBL 200W

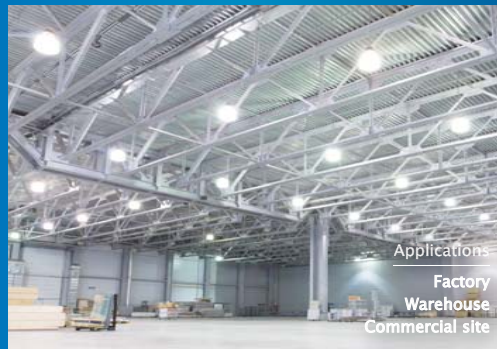

Alder High Bay Light saves more than 70% of energy with its high system efficiency up to 157 lm/W. With the features of light-weight, different mounting options and longer time service, it delivers the benefits of less maintenance and more economical solution. Ideal applications are for factories, sport fields, warehouses and distribution centers.



Applications
Factory
Warehouse
Commercial site



Product Overview

Features

- Slim profile design, easy for installation
- Perfect resistant coating
- Rotatable bracket made of stainless steel
- System efficacy up to 157 lm/W (Ra > 70)
- Emergency kit and motion sensor available
- Dimmable 1-10V optional

Specifications

- Power Consumption : 200 W
- Input Voltage : AC 90-305 V
- Frequency : 50/60 Hz
- Operation Temp. : -30°C to +50°C
- LED Lifetime (L70) : 60,000 hours

Dimensions [Unit : mm]

E39/E40

Weight : 2.5 Kg

External Driver

STR

Weight : 5.3 Kg

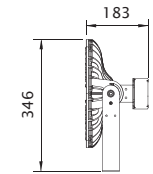
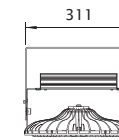
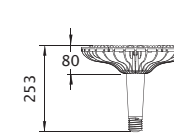
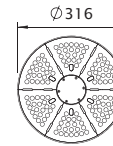

SPO

Weight : 5.8 Kg

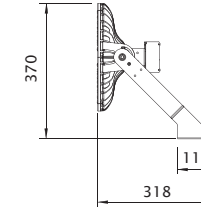
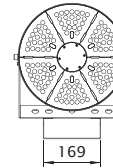

Photometric [Figures are shown in steady stage]

Beam Angle 30°

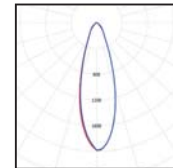

M	Clear (5000K, C8)
3	4717 LUX
6	1179 LUX
9	524 LUX

Beam Angle 60°

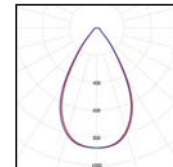

M	Clear (5000K, C8)
3	2444 LUX
6	611 LUX
9	272 LUX

Beam Angle 100°

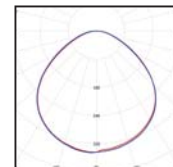

M	Clear (5000K, C8)
3	898 LUX
6	225 LUX
9	100 LUX

Ordering Information

Product Name	Lens Option	CCT (K)	Beam Angle (°)	CRI	Light Output Steady Stage (lm)	Light Output Cold Stage (lm)	Cert.
HBL-200S-T(D)-cyyy-T6WD30C7	Clear	5000	30	>70	28200	31300	ETL/FCC/PSE
HBL-200S-T(D)-cyyy-T6WD60C7	Clear	5000	60	>70	28200	31300	ETL/FCC/PSE
HBL-200S-T(D)-cyyy-T6WDA0C7	Clear	5000	100	>70	26500	29400	ETL/FCC/PSE
HBL-200S-T(D)-myyy-T6WDA0C7	Frosted	5000	100	>70	21200	23600	PSE
HBL-200S-T(D)-cyyy-T6WD30C8	Clear	5000	30	>80	26400	29300	ETL/FCC/PSE
HBL-200S-T(D)-cyyy-T6WD60C8	Clear	5000	60	>80	26400	29300	ETL/FCC/PSE
HBL-200S-T(D)-cyyy-T6WDA0C8	Clear	5000	100	>80	24700	27500	ETL/FCC/PSE
HBL-200S-T(D)-myyy-T6WDA0C8	Frosted	5000	100	>80	19800	22000	PSE
HBL-200S-TD-cSTR-T6WD30C8	Clear	5000	30	>80	26400	29300	DLC
HBL-200S-TD-cSTR-T6WD60C8	Clear	5000	60	>80	26400	29300	DLC
HBL-200S-TD-cSTR-T6WDA0C8	Clear	5000	100	>80	24700	27500	DLC

* Other CCT options : 3000K, 4000K, 6500K.

* Other CCT options : 4000K.

* CCT 5000K only.

* Dimmable 1-10V optional.