

Din Rail 5 in 1 LED controller (WiFi + 2.4G)

Model No.:TW5

Features

- WiFi + 2.4Ghz wireless transmitting
- Compatible with standard 35mm universal rail
- 16 million colors adjustable, Saturation, RGB, Brightness, color temperature adjustable
- Built-in 18 dynamic mode with jumping, gradually changing(only for 2.4G remote control)
- Auto-forwarding: Automatically forward the remote control signal to another controller, making the remote control distance infinite
- Automatic synchronization: The same dynamic mode is automatically synchronized, so that the mode is always consistent
- Have DND function, usually used in power failure area and save power
- Support TUYA SMART app control
- Support third party voice control like Alexa, Google assistant,Yandex Alice, Tmall Genie,Baidu and Xiaomi

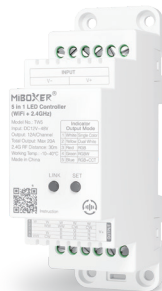

Parameters

| | | |
|--|------------------------|---|
| Name: Din Rail 5 in 1 LED controller | IP Rating: | IP20 |
| Model No.: TW5 | Working Temperature: | -10~40°C |
| Input Voltage: DC12~24V | EMC Standard (EMC): | ETSI EN 301 489-1 V2.2.3(2019-11) ETSI EN 301 489-3 V2.3.2 (2023-01) |
| Output Current: 12A/ Channel | Safety Standard (LVD): | EN 61347-1: 2015+A1:2021 EN 61347-2-11: 2001+A1:2019 |
| Total Output: Max 20A | Radio Equipment (RED): | ETSI EN 300 328 V2.2.2 (2019-07) |
| Protocol: WiFi + 2.4G | Certification: | CE, EMC, LVD, RED |
| Control Distance: RF: 30m | | |
| WiFi Standard: IEEE 802.11b/g/n 2.4GHz | | |

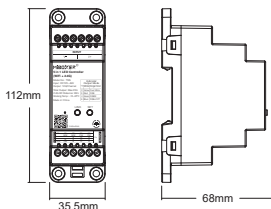

DIN-Rail mounting size:
TS-35/7.5 or TS-35/15
(Purchasing separately)



Connection Diagram

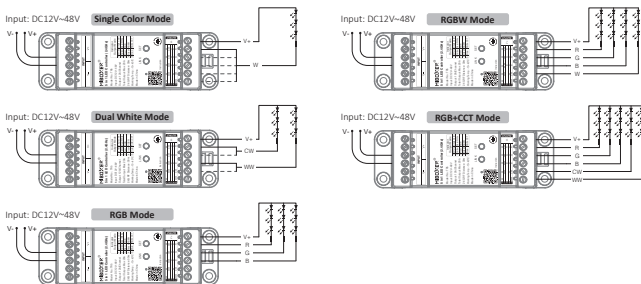

Setting Output Mode

Output mode is related with connected led lights

Solution: short press " SET " to switch mode (attention: it will step out automatically without any operation within 3 seconds)



| Indicator Output Mode | |
|-----------------------|--------------------|
| 1 | White Single Color |
| 2 | Yellow Dual White |
| 3 | Red RGB |
| 4 | Green RGBW |
| 5 | Blue RGB+CCT |

Application Diagram

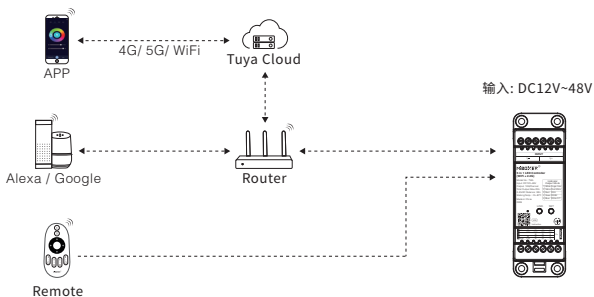

Compatible with these 2.4G RF remote controls (Purchased separately)

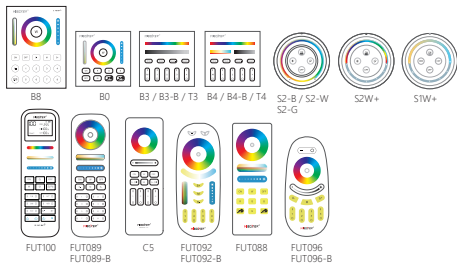

2.4G RF Remote control instruction

Linking Code Instructions

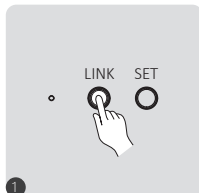

Short press "Link" button once



Short press " I " button 3 times within 3 seconds.



Lights blink 3 times slowly means linking is done successfully.



Linking failed if light is not blinking slowly, Please follow above steps again. (Note: Light that have linked can't link again)

Unlinking Code Instructions

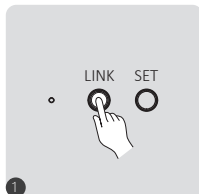

Short press "Link" button once



Short press " I " button 5 times within 3 seconds.



Lights blink 10 times quickly means unlinking is done successfully.



Unlinking failed if light is not blinking quickly, Please follow above steps again. (Note: Light haven't linked that don't need to unlink)

Dynamic mode table selection (only for remote control)

Select dynamic mode table 1:

While the light is in static mode, short press “**S+**” button 5 times quickly until blue light flashes 3 times slowly, static mode is activated successfully.

Select dynamic mode table 2:

While the light is in static mode, short press “**S-**” button 5 times quickly until yellow light flashes 3 times slowly, static mode is activated successfully.

Dynamic mode table 1 (default)

| Number | Dynamic Mode | Brightness / Saturation / Speed |
|--------|------------------------|---------------------------------|
| 1 | Mardi Gras | Adjustable |
| 2 | Automatic color change | |
| 3 | Sam | |
| 4 | Gemstone | |
| 5 | Twilight | |
| 6 | American | |
| 7 | Fat Tuesday | |
| 8 | Party | |
| 9 | Slow Color Splash | |

Dynamic mode table 2 (need to switch manually)

| Number | Dynamic Mode | Brightness / Saturation / Speed |
|--------|--|---------------------------------|
| 1 | Seven colors gradual change | Adjustable |
| 2 | White light Gradual change | |
| 3 | RGB gradual change | |
| 4 | Seven colors jump to change | |
| 5 | Jump to change randomly | |
| 6 | Red light gradual change +Flash 3 times | |
| 7 | Green light gradual change +Flash 3 times | |
| 8 | Blue light gradual change +Flash 3 times | |
| 9 | White light gradual change +Flash 3 times | |

Auto transmitting & Synchronization (only for remote control)

Remote signal auto transmitting

One light can transmit the signals from the remote control to another light within 30m, as long as there is a light within 30m, the remote control distance can be limitless.

Dynamic modes auto synchronization

Multi lights can synchronize if they are in same dynamic mode and linked with same remote (distance between each light is within 30m)

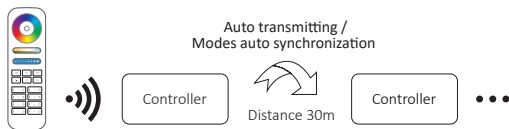

Turn Do Not Disturb mode on and off (ON by default)

Turn on "Do Not Disturb" (applicable to areas with frequent power outages to save energy)

Turn on Do Not Disturb mode:

Short press the "OFF" button 3 times within 3 seconds, and then short press the "ON" button 3 times. The light flashes 4 times to indicate success.

Note: When the lamp is powered on again after a power outage, its status (lights on or off) will remain the same as before the power outage.

Turn off Do Not Disturb mode:

Short press the "ON" button 3 times within 3 seconds, and then short press the "OFF" button 3 times. The light flashes 4 times slowly to indicate successful shutdown.

Note: When the lamp is powered on again after a power outage, its status will be on by default.

Smartphone app control instruction

Network Configuration (Don't support 5G router)

1). Download and install [Tuya Smart] app

Search for [Tuya Smart] in Apple or Google store or scan following QR code to download and install the app.

Please open the app click " Register " button to create account while using it in the first time, Log in directly if you already had account.



2). Network Configuration

- (1) Connect controller with power supply.
- (2) Confirm indicator light is flashing quickly (2 flashes per second),
If indicator light isn't in fast flashing state, there are two ways to enter:
 - Long press " LINK " key until indicator light flashing quickly.
 - Power off and on controller 6 times.
- (3) Connect phone with home WiFi network in the 2.4GHz frequency.
- (4) Open homepage of app and click " + " button at the upper right corner of page.
- (5) Click " Lighting " on the left side of page and then click " Light Source (BLE+Wi-Fi) "
- (6) Follow app prompts to complete configuration.

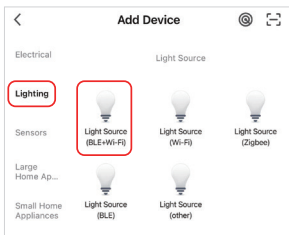
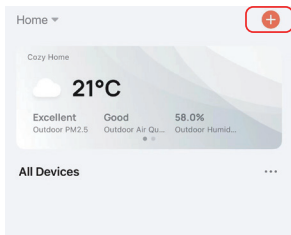

App turn on and off "Do Not Disturb" mode (default activated)

Click the light which need to be set up or group control --- click "More" --- click "Power-on behavior" --- turn on or off

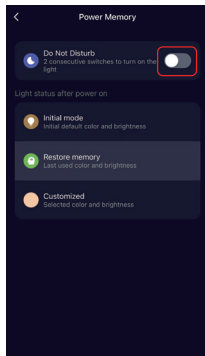
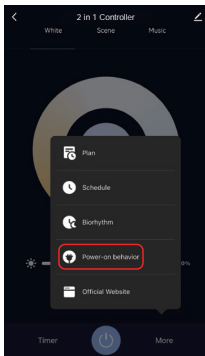
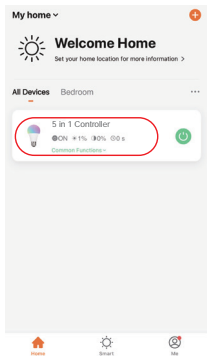

Alexa voice control instruction

Please add device into **[Tuya Smart]** app, then start following steps

- 1). Open Alexa App
- 2). Click "More" on the bottom of right corner
- 3). Click "Skills & Games"

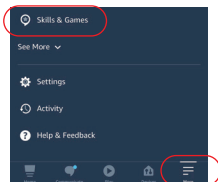

- 4). Click "Q" on the top of right corner
- 5). Type into "Smart life" and search

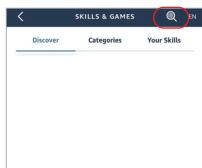

- 6). Click "Smart Life" skill, follow instruction to finish configuration and start voice control

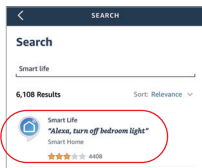

Google Home voice control instruction

Please add device into **[Tuya Smart]** app, then start following steps

- 1). Open Google Home App
- 2). Click “+” on the top of left corner

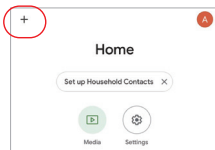

- 3). Click “Set up device”

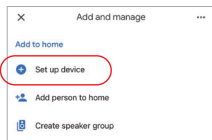

- 4). Click “Works with Google”

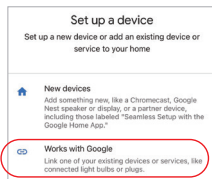

- 5). Click “Q” on the top of right corner
- 6). Type into “Smart life” and search
- 7). Click “Smart Life” skill, follow instruction to finish configuration and start voice control

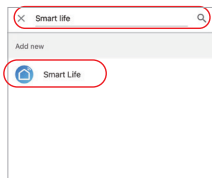

Notice

1. Please check whether the voltage of the power supply is in accordance with the light, and please check the connection of both the cathode and anode, otherwise the light will be broken.
2. Please don't connect wires with power on. Please turn on again only when it is in right connection and no short circuit.
3. Non-professional user cannot dismantle the lighting fixtures directly.
4. Please do not use the light in the place with widely range metal area or strong electromagnetic wave nearby, otherwise, the remote distance will be seriously affected.



Dimmer can not
use in humid area

Made in China